



4 LANE RACING SET

OWNER'S MANUAL



PARTS

P1 : Control Center x 1

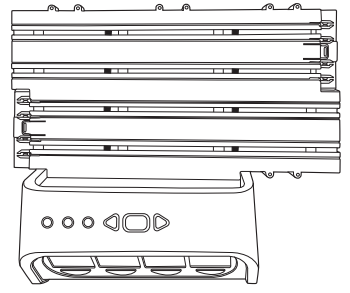

P2 : Straight Track x 3

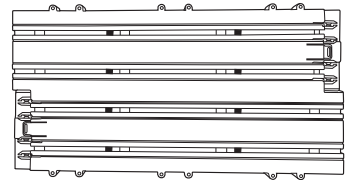

P3 : Curve Track x 12

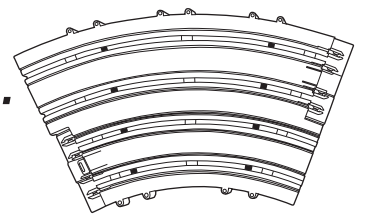

P4 : Wire Connection Speed Controller x 4

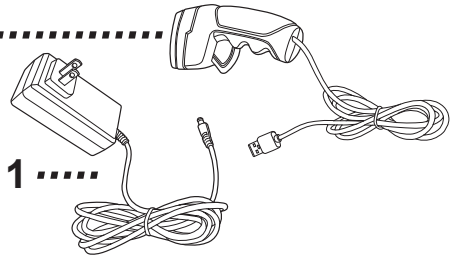

P5 : AC/DC Electric Adaptor (Please Note Remark) x 1

P6 : Straight Track Fence x 7

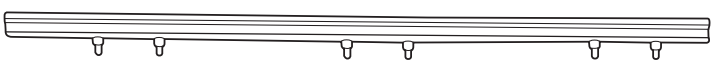

P7 : Control Center Fence x 1

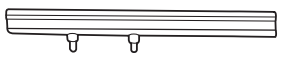

P8 : Long Fence Curve Track x 12

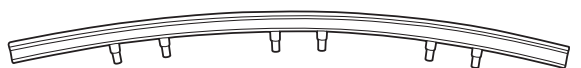

P9 : Curve Track Short Fence x 12



P10 : Stacking Stone Stack up Bridge Stone x 32

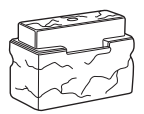

P11 : Stone Base x 12

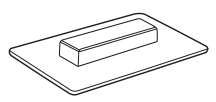

P12 : Bridge Stone Grip x 12



P13 : Racing Car x 4



Remark : The adaptor supplied will be based on the particular socket used in each country.

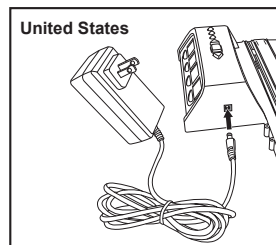
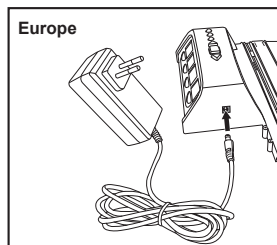
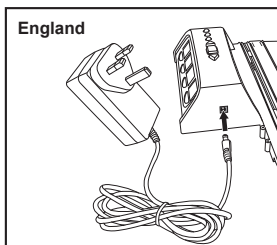

ASSEMBLY AND DETACH OF TRACKS

Power connection

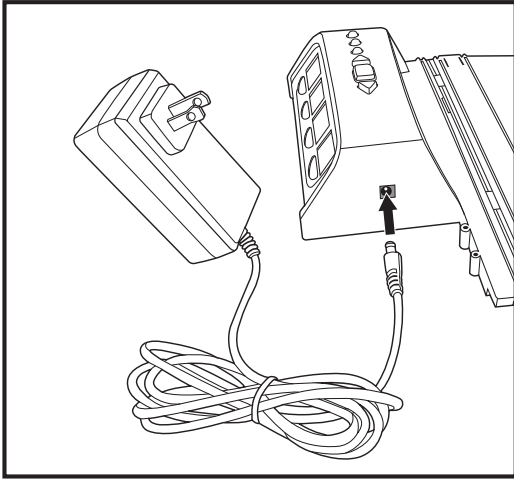

Hand controller connection

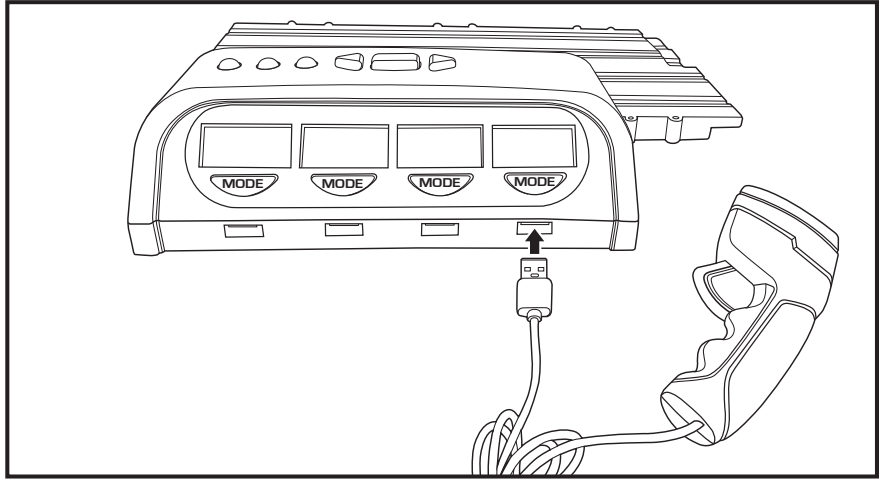

Tracks connection

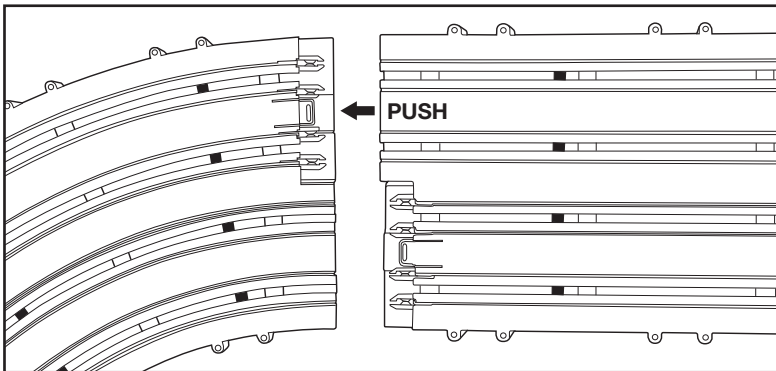

Fence connect to track

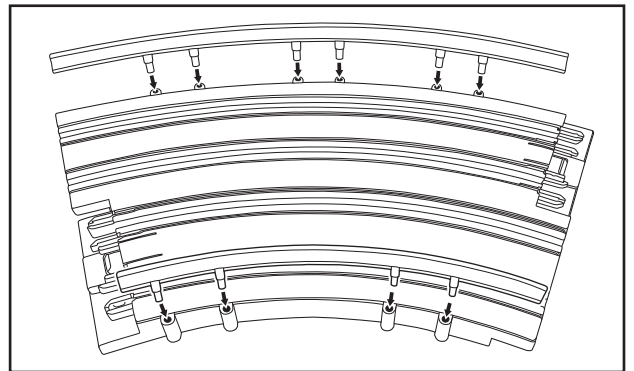

Bridge stone stacking

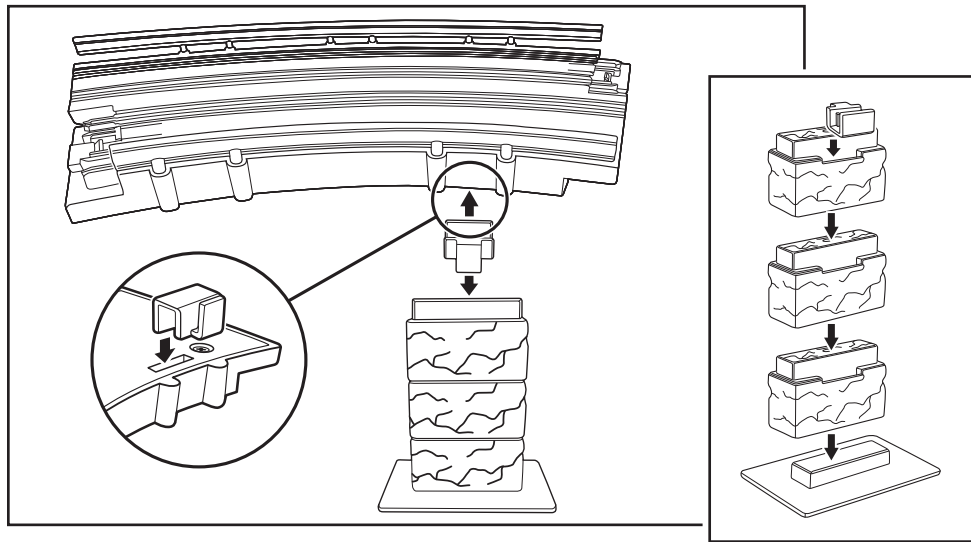

To detach tracks

Step 1

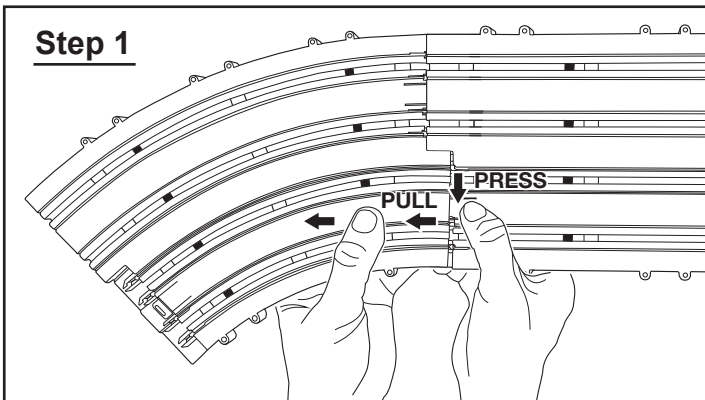

Step 2

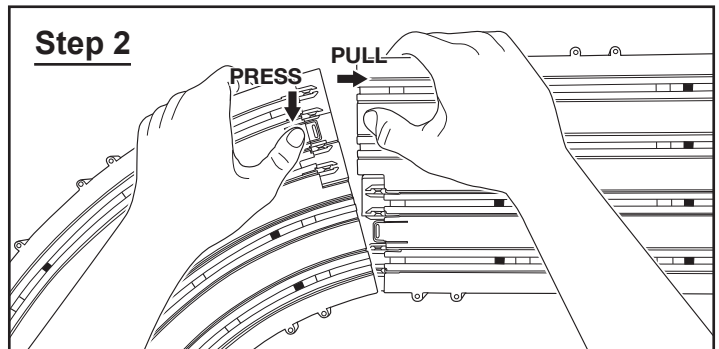

RACE WITH THE WIRE SPEED CONTROLLER

Control Center

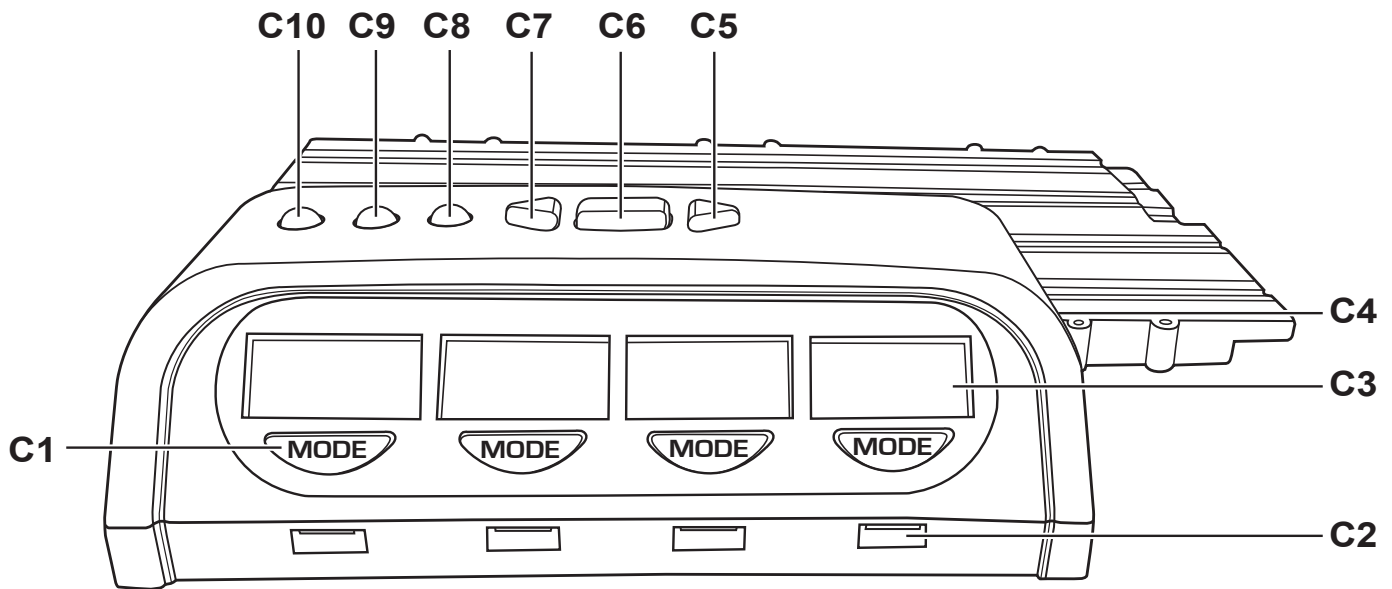

C1 : Individual mode Button of each lane

C2 : USB Connector for the Wire Speed Controller

C3 : LED

C4 : AC / DC Power Adaptor Jack

C5 : Selection Button

C6 : Central Mode and Confirm Button

C7 : Selection Button

C8 : Racer Indication Light Red

C9 : Racer Indication Light Yellow

C10 : Racer Indication Light Green

Note : The hand control and wifi control DO NOT work at the same time, hand control only function when wifi is turned off/ discounted.

Individual Mode button of each lane (C1)

The control center has 4 individual mode buttons, each button related to one lane, racers can press button of the desired lane to registered colour of the light for easy identification of lane to be raced, also to read the result of race after each race.

Choose of light colour of the lane

A sign “**LIGHT**” will show on the **LED** of the control center when press the **MODE** button, press the selection button (C5) or (C7) to select light colour on the lane then press the confirm button (C6) to register the lane.

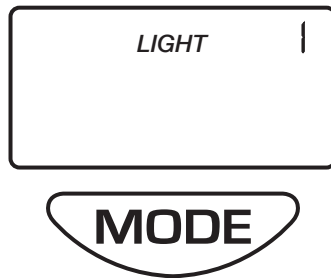

Check racing result

You can check the racing time of each lap or total racing time of a specific lap.

To check the result of each lap, press the **MODE** button until the **LED** shows “**TIME**” then press selection button (C5) or (C7), the **LED** will show the number of **LAPS** and also the racing time of that **LAP**.

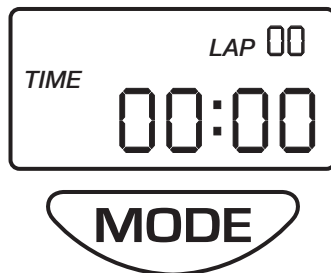

To check total racing time of a specific lap, press the **MODE** button until the **LED** shows “**TOTAL**” then press selection button (C5) or (C7) to the specific **LAP** number to show the racing time of that lap.

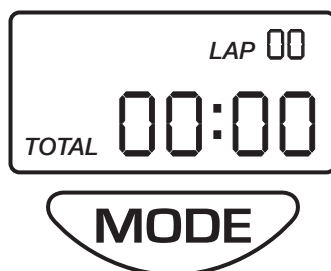

Control Center mode/confirm button (C6)

The mode/confirm button can be number of laps to race, command the racing light (C8,C9 and C10) and to start racing also to confirm all settings.

To set number of laps to be raced

Press the **MODE** button (C6) to **PRESET** and the **LAP** numbers will blink. Then press the button (C5) or (C7) to set the number of lap to be raced. Then press the **MODE** button to confirm. A **“START”** sign then shows which means that the race is ready to race.

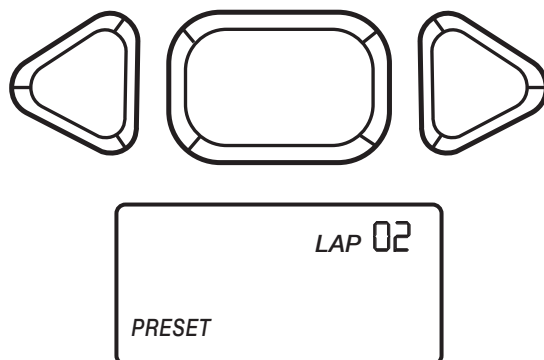

To Race

Once the LED shows “START” press the confirm button. The indication light on the control center will light up in the following order: Red (C8), yellow (C9) then green (C10), You can then use the speed controller to race.

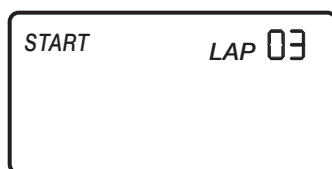

Wire connection speed controller (C2)

Control the speed of the car by pulling the trigger on the controller.

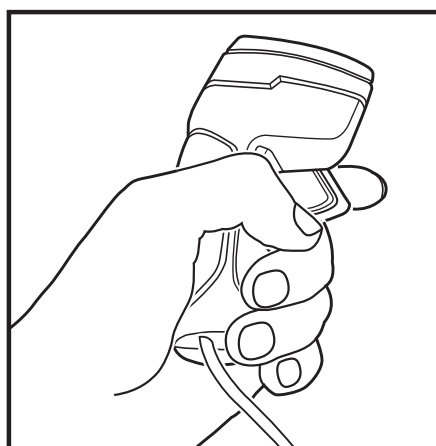

Remark: If a player wants to stop the race in the middle of the race, press the MODE button.

WIFI WIRELESS CONTROL



This racing set can be controlled using the “SLOTTRACE” app. To download the app please Scan the QR code below.

Administrator Screen

To begin the race, an administrator has to be selected among members who are going to join the race, the administrator has the responsibility to input information regarding the total length of the track by counting the number of pieces of track which will share on all members’ screen, also taking photo of the track, set the number of laps and start the race as well. Each race has only one administrator, the first member who register to the race will be the administrator, all other members can join the race after registration of the administrator.

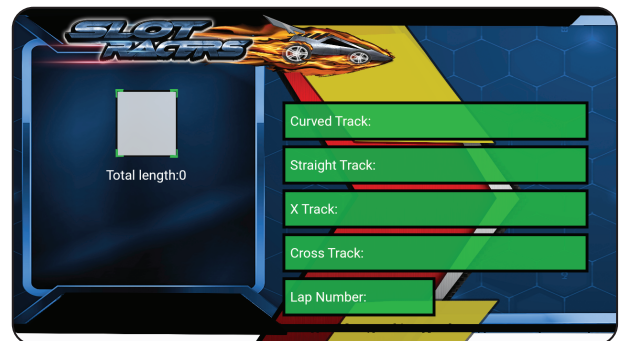

Main Panel

The main panel will pop up once the app is downloaded, press registration to go to the registration panel



Registration Panel

The racer can fill in following information

Name of racer

Age

Gender

Body height

After all the information is filled in press confirm then go to the ‘photo taking’ screen



Photo Taking Screen

Press the “click here to access camera button” to go to the camera to take picture, after picture is taken then press confirm to go to helmet selection panel

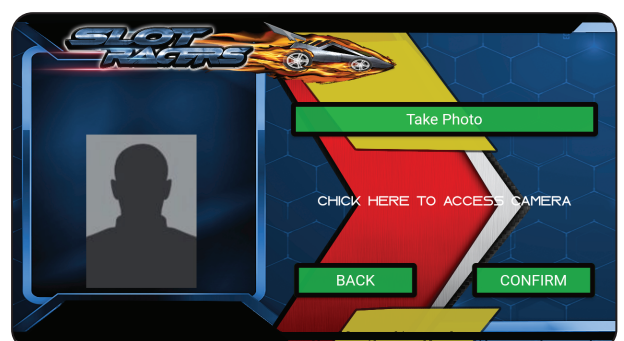

Helmet Selection Screen

Press the selected screen then press confirm to go to racing outfit screen



Outfit Selection Screen

Press the selected outfit then press confirm to go to the racing car panel



Car Registration Screen

Scan the QR code at the bottom of the car to upload the specification of the car also the picture, then press the confirm button to move to the lane selection screen

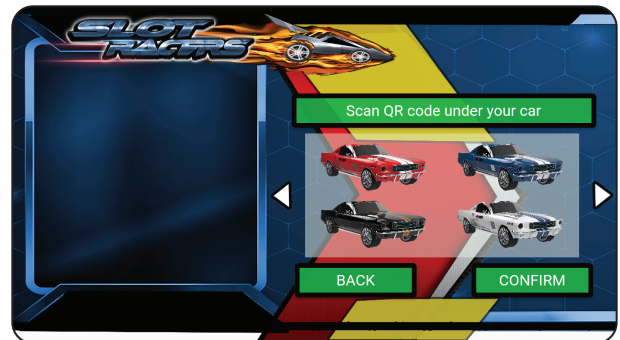

Lane Selection Screen

Racers can choose the lane on the track by pressing the number of the lane on the screen, after the lane is selected press confirm to go to lane light color selection screen

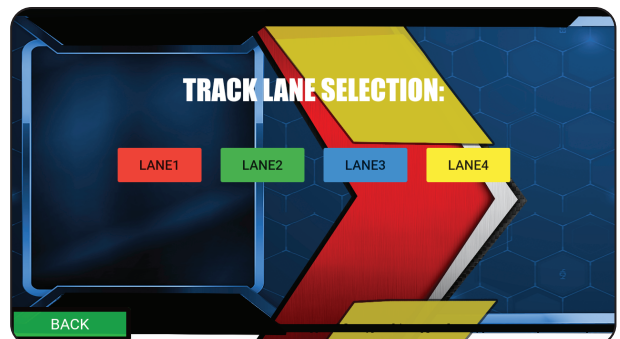

Lane Color Selection Panel

Racer can choose the colour of light on the lane, after the colour of light is selected press next to the racing panel



Racing Panel

On the panel it will show all information of the racer also a speed control bar, the left side is stop and you can push the button on the speed control to the right hand side to control speed of the car.

